

South to
Charleston
WV

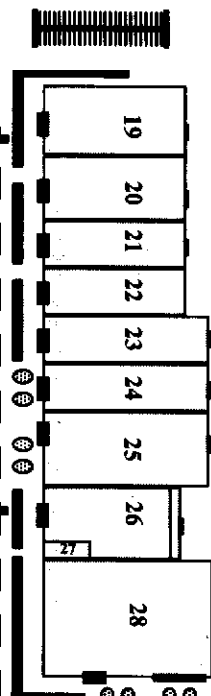

North to
Clarksburg
WV

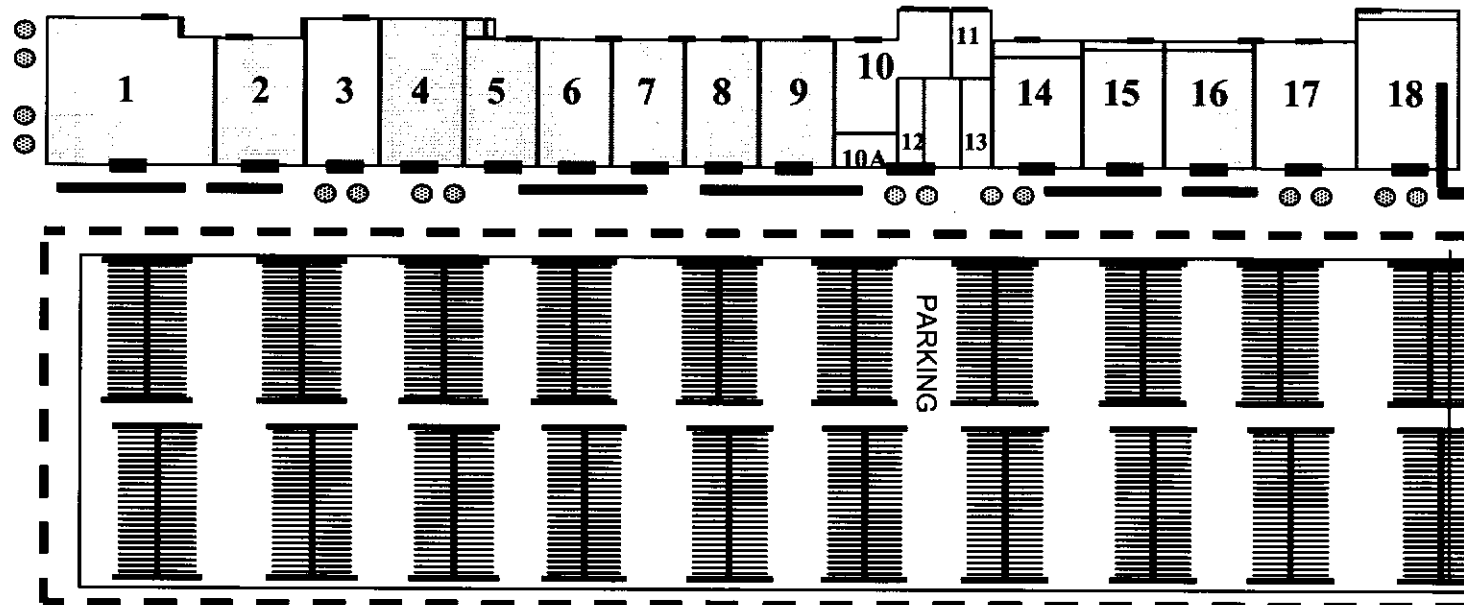

- | | |
|---------------------------------|---------------------------|
| 1. WV DMV | 19. VA Medical Center |
| 2. Corning | 20. Available |
| 3. Available | 21. Hawkins Leather |
| 4. Tommy Hilfiger | 22. Bon Worth |
| 5. Jerry's Sporting Goods | 23. Wild Vine and Spirits |
| 6. Jerry's Sporting Goods | 24. Rue 21 |
| 7. Jerry's Sporting Goods | 25. Dress Barn |
| 8. Book Cellar | 26. Everything Fiesta |
| 9. Available | 28. Amish Farms |
| 10. China Buffet | |
| 11. Available | |
| 14. Visitors Center/ Enterprise | |
| 15. Available | |
| 16. Mattress Warehouse Outlet | |
| 17. Hanes/Legg's/Bali | |
| 18. Famous Footwear | |

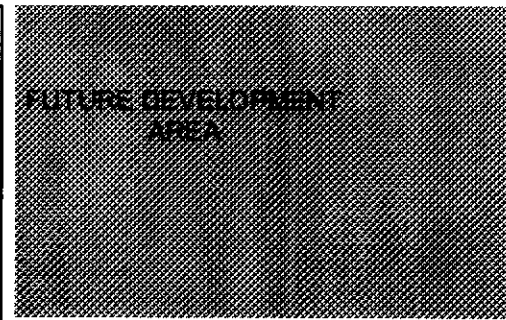

Shoney's
Restaurant

Boyd's Bear
Heaven
Sunoco

SKIDMORE LANE

Farmers
Market

Wendy's

I-79 EXIT RAMP



Flatwoods Factory Outlet Stores

304-765-7880

Flatwoods Outlet Stores Phase I

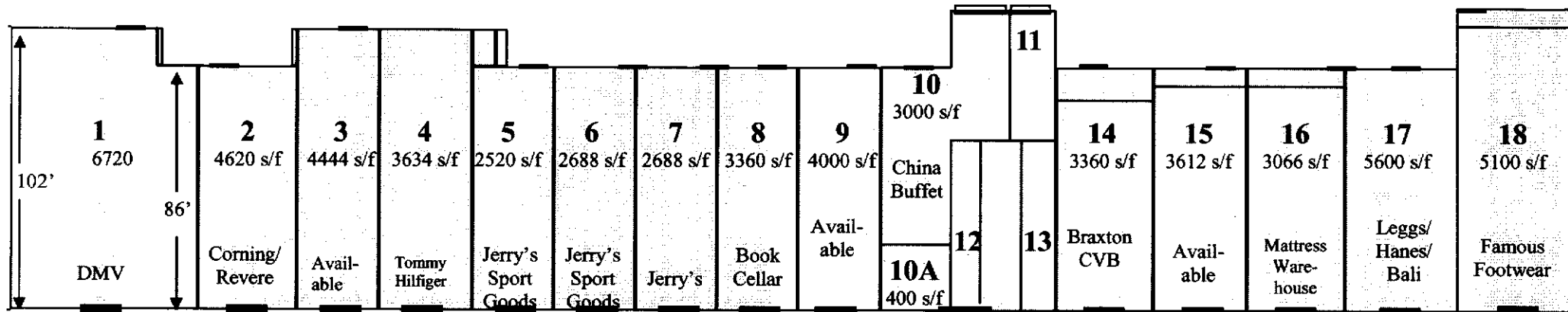

UNIT	TENANT	TOTAL SQ. FEET	UNIT	TENANT	TOTAL SQ. FEET
1	WV Dept. of Motor Vehicles	6720	10	China Buffet	3000
2	Corning Revere	4620	10A	Lost Road Candles	400
3	Available	4444	11	Available	1000
4	Tommy Hilfiger	3634	12	Restrooms	
5	Jerry's Sporting Goods	2520	13	Restrooms	
6	Jerry's Sporting Goods	2688	14	Braxton CVB/Enterprise	3360
7	Jerry's Sporting Goods	2688	15	Available	3612
8	Book Cellar	3360	16	Mattress Warehouse Outlet	3066
9	Available	4000	17	Legg's/Hanes/Bali	5600
			18	Famous Footwear	5100

Flatwoods Outlet Stores Phase II

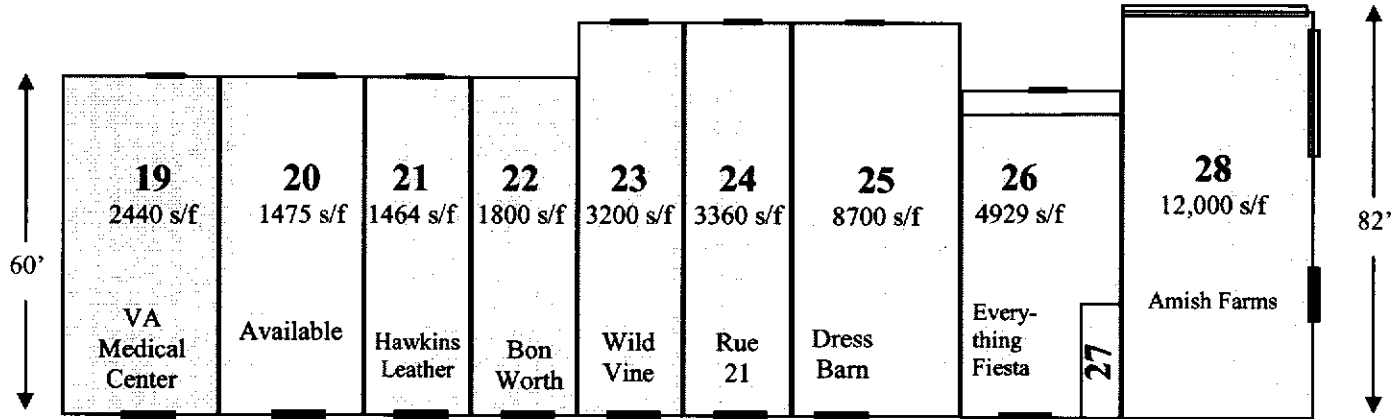

	TENANT	TOTAL SQ FEET
19	VA Medical Center	2440
20	Available	1475
21	Hawkins Leather	1464
22	Bon Worth	1800
23	Wild Vine and Spirits	3200
24	Rue 21	3360
25	Dress Barn	8700
26	Everything Fiesta Homer Laughlin China	4929
27	Restrooms	
28	Amish Farms	12,000